

Transient Voltage Suppressor Diodes

Uni-directional

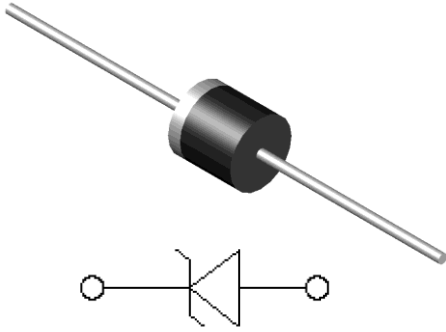

Features

- Excellent clamping capability
- Low dynamic impedance
- Solder dip 275 °C max. 7 s, per JESD 22-B106

Bi-directional

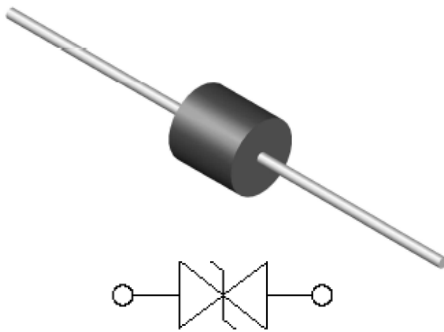

Mechanical Data

- **Package:** R-6
Molding compound meets UL 94 V-0 flammability rating, RoHS-compliant
- **Terminals:** Tin plated leads, solderable per J-STD-002 and JESD22-B102
- **Polarity:** Color band denotes cathode end

■Maximum Ratings (Ta=25°C Unless otherwise specified)

PARAMETER	SYMBOL	UNIT	Max
Peak power dissipation, with a 10/1000us waveform ⁽¹⁾	P_{PPM}	W	15000
Peak pulse current, with a 10/1000us waveform ⁽¹⁾	I_{PPM}	A	See Next Table
Power dissipation, on infinite heat sink at TL=75°C	P_D	W	8.0
Operating junction and storage temperature range	T_J, T_{STG}	°C	-55 to +150

Notes:

(1) Non-repetitive current pulse, per Fig. 3 and derated above $T_A = 25^\circ\text{C}$ per Fig.2.

■Ordering Information (Example)

PREFERED P/N	PACKAGE CODE	UNIT WEIGHT(g)	MINIMUM PACKAGE(pcs)	INNER BOX QUANTITY(pcs)	OUTER CARTON QUANTITY(pcs)	DELIVERY MODE
15KP SERIES	D1	Approximate 2.6	500	500	5000	Tape
15KP SERIES	C1	Approximate 2.6	100	100	5000	Bulk



15KP SERIES

■Electrical Characteristics (T_a=25°C Unless otherwise specified)

Part Number (Uni)	Part Number (Bi)	Breakdown Voltage V _{BR} @I _T			Maximum Reverse Leakage I _R @ V _{WM} (μA)	Working Peak Reverse Voltage V _{RWM} (V)	Maximum Reverse Surge Current I _{PP} (A)	Maximum Clamping Voltage V _c @ I _{PP} (V)
		Min(V)	Max (V)	I _T (mA)				
15KP17A	15KP17CA	18.9	20.79	50	5000	17	512	29.3
15KP18A	15KP18CA	20	22.01	50	5000	18	485	30.9
15KP20A	15KP20CA	22.2	24.46	20	1500	20	437	34.3
15KP22A	15KP22CA	24.4	26.91	10	500	22	404	37.1
15KP24A	15KP24CA	26.7	29.35	5	150	24	369	40.5
15KP26A	15KP26CA	28.9	31.8	5	50	26	347	44
15KP28A	15KP28CA	31.1	34.24	5	25	28	316	47.5
15KP30A	15KP30CA	33.3	36.69	5	15	30	296	50.7
15KP33A	15KP33CA	36.7	40.4	5	10	33	274	54.8
15KP36A	15KP36CA	40	44	5	10	36	251	59.7
15KP40A	15KP40CA	44.4	48.9	5	10	40	228	65.8
15KP43A	15KP43CA	47.8	52.6	5	10	43	215	69.7
15KP45A	15KP45CA	50	55	5	10	45	205	73
15KP48A	15KP48CA	53.3	58.7	5	10	48	193	77.7
15KP51A	15KP51CA	56.7	62.4	5	10	51	181	82.8
15KP54A	15KP54CA	60	66	5	10	54	171	87.5
15KP58A	15KP58CA	64.4	70.9	5	10	58	160	94
15KP60A	15KP60CA	66.7	73.4	5	10	60	154	97.3
15KP64A	15KP64CA	71.1	78.3	5	10	64	144	104
15KP70A	15KP70CA	77.8	85.6	5	10	70	132	114
15KP75A	15KP75CA	83.3	91.7	5	10	75	123	122
15KP78A	15KP78CA	86.7	95.4	5	10	78	119	126
15KP85A	15KP85CA	94.4	104	5	10	85	109	137
15KP90A	15KP90CA	100	110.1	5	10	90	103	146
15KP100A	15KP100CA	111	122.3	5	10	100	93	162
15KP110A	15KP110CA	122	134.5	5	10	110	84	178
15KP120A	15KP120CA	133	146.8	5	10	120	78	193
15KP130A	15KP130CA	144	159	5	10	130	72	209
15KP150A	15KP150CA	167	183.5	5	10	150	62	243
15KP160A	15KP160CA	178	195.7	5	10	160	58	259
15KP170A	15KP170CA	189	207.9	5	10	170	55	275
15KP180A	15KP180CA	200	220.1	5	10	180	52	291
15KP200A	15KP200CA	222	244.6	5	10	200	47	322
15KP220A	15KP220CA	245	269.1	5	10	220	42	356
15KP240A	15KP240CA	267	293.5	5	10	240	39	388
15KP260A	15KP260CA	289	318	5	10	260	36	419
15KP280A	15KP280CA	311	342.4	5	10	280	33	452



15KP SERIES

■ Characteristics (Typical)

FIG1: Peak Pulse Power Rating Curve

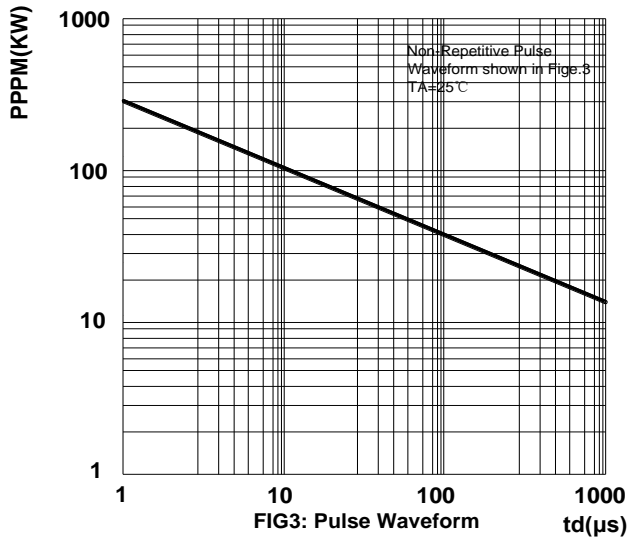

FIG4: Pulse Power or Current vs Initial Junction Temperature

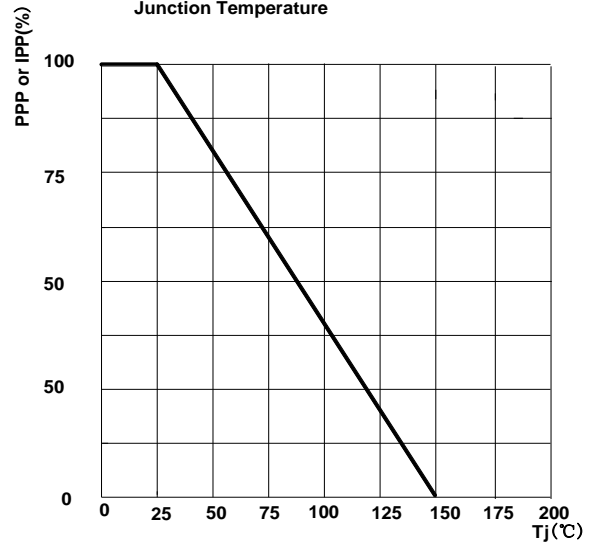

FIG3: Pulse Waveform

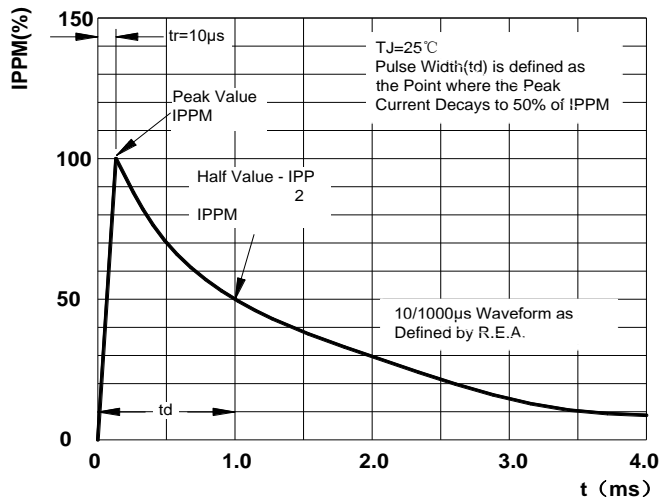
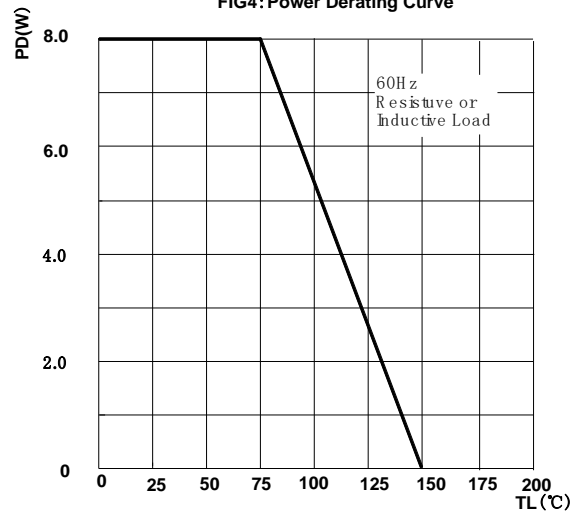

FIG4: Power Derating Curve





15KP SERIES

■ Outline Dimensions

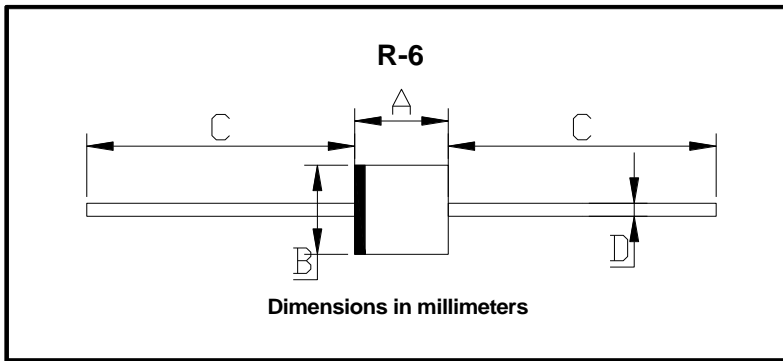

R-6		
Dim	Min	Max
A	8.60	9.10
B	8.60	9.10
C	25.4	/
D	1.20	1.32



15KP SERIES

Disclaimer

The information presented in this document is for reference only. Yangzhou Yangjie Electronic Technology Co., Ltd. reserves the right to make changes without notice for the specification of the products displayed herein to improve reliability, function or design or otherwise.

The product listed herein is designed to be used with ordinary electronic equipment or devices, and not designed to be used with equipment or devices which require high level of reliability and the malfunction of which would directly endanger human life (such as medical instruments, transportation equipment, aerospace machinery, nuclear-reactor controllers, fuel controllers and other safety devices), Yangjie or anyone on its behalf, assumes no responsibility or liability for any damages resulting from such improper use of sale.

This publication supersedes & replaces all information previously supplied. For additional information, please visit our website [http:// www.21yangjie.com](http://www.21yangjie.com) , or consult your nearest Yangjie's sales office for further assistance.